

# Profiles Bituminous Waterproofing



**BMI** icopal

The UK's premium bitumen roofing solution:  
quality without compromise, for proven performance.

[bmigroup.com/uk](http://bmigroup.com/uk)



BMI ICOPAL PROFILES





# Quality without compromise

**At BMI Icopal, we're committed to quality. That's the BMI Icopal way, and the reason Profiles bituminous flat roof waterproofing systems are perfectly suited to UK conditions and the challenges of UK projects, installed exclusively by the IMA Approved Contractor Network with uncompromising pride and care.**

Profiles systems are supported by unrivalled services, from diagnostic roof survey technology that meticulously maps your project needs, to working with you as a trusted advisor, writing specifications with insightful, evidence-based recommendations, to deliver a custom, fully traceable solution. And it's assured by a complete system and workmanship guarantee that reduces risk and minimises liability.

All of this is done with quality foremost, as part of a tailored experience that gives you absolute control, cost certainty and reassurance that your specified roof will perform and protect your clients' investments for decades.



Explore the full scope of our support [for our Profiles system](https://bmigroup.com/uk)

# Why choose Profiles?

**As roofing experts, you can rely on Icopal to understand the challenges you face. That's why our Profiles range of bituminous systems encompasses torch-on and TorchSafe® roofing solutions designed to save time on new and refurbishment flat roofing projects, whilst also ensuring safe working practices and exceptional, proven performance.**

Whatever your challenge, Profiles has the materials, components and accessories to solve it – and whether concrete, wood or metal substrate, this is a system that flexes to your needs.

It's all backed by comprehensive technical support. From cutting-edge moisture mapping technology to training and site inspections, our trusted Technical Team partners with yours to take you effortlessly from design and specification to installation and aftercare.



ICOPAL MOISTURE MAPPING PROCESS

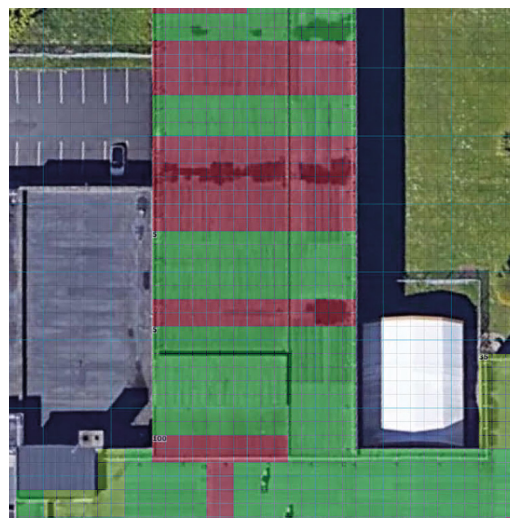

Utilising the Icopal moisture mapping service enables evidence-based decision making, and improved cost certainty for your project.

EXAMPLE MOISTURE MAP, AREAS THAT ARE RED DEPICT MOISTURE INGRESS.



**30** YEAR  
GUARANTEE

Profiles benefits from the complete certainty and peace of mind of a full Icopal system guarantee, covering you for up to 30 years

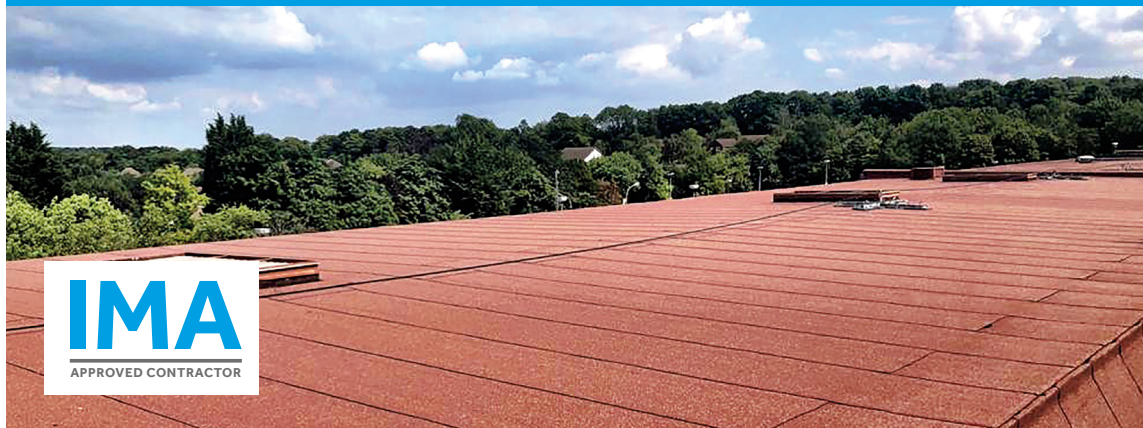

# Always in expert hands

## Profiles is exclusively installed by IMA contractor members

The IMA (Intelligent Membrane Association) is an association of Icopal-approved roofing contractors offering a guaranteed level of exceptional service, skill & technical expertise. IMA contractors adhere to the highest standards of quality, workmanship, and health and safety – meaning the installation of your roof is in the very best hands.



**Visit our website to discover more about**  
**[our IMA approved contractor network](#)**

### SAFETY, QUALITY AND ENVIRONMENT

Profiles membranes are manufactured under a Quality Management System approved to ISO 9001: 2015 [Certificate number 4410021410102] and an Environmental Management System approved to ISO 14001: 2015 [Certificate number 4410021410102] by TÜV NORD CERT GmbH.





# Key benefits

**Profiles is our most premium range of bituminous waterproofing systems, with uncompromising quality, supported by industry-leading roof surveys and condition reporting, using evidence-based diagnostic technology for absolute certainty and peace of mind.**

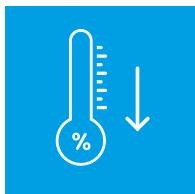

## SAFER

Safer low-flame application, thanks to our technically advanced, low-heat-reactive SBS modified bitumen formulation

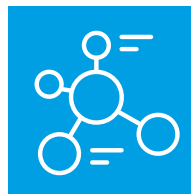

## SERVICES

As well as our site and specification services, our roof surveys also use cutting-edge diagnostic technologies to give you evidence and objective recommendations for absolute project certainty



## RANGE OF COLOURS

A range of cap sheet colours are available to suit every project

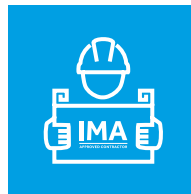

## INSTALLATION

**Exclusively installed by IMA-approved contractors**

Project quality monitoring and sign-off is provided by the Icopal Site Inspection Team for projects requiring a system guarantee

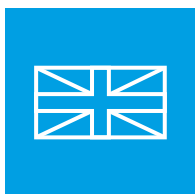

## SYSTEM

Designed and manufactured in the UK to meet our unique environment and project demands



## GROOVE TECHNOLOGY

Delivering a larger surface area and a faster, more secure bond with less torching required, our patented groove technology maximises adhesion and energy efficiency

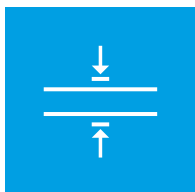

## HIGH PERFORMANCE

Profiles delivers the most robust cap sheet and waterproofing system available, with high-performance reinforcements, up to 5mm membrane thickness.



## SAFE2TORCH TECHNOLOGY

Safe2Torch-compliant systems available, incorporating TorchSafe™ membrane technology, for enhanced safety during application

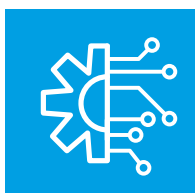

## FIRESMART TECHNOLOGY

Incorporates FireSmart® technology that incorporates a specialist fire retardant additive

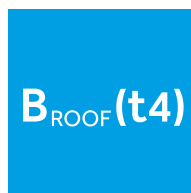

## B<sub>ROOF</sub> (t4)

All BMI Icopal approved bituminous roofing systems are B<sub>ROOF</sub> (t4) compliant\*



**Profiles is enhanced by our most comprehensive range of specialist support:**



**Comprehensive roof surveys**



**Tapered insulation design**



**Condition reports**



**U-value and Annex E thermal calculations**



**Moisture mapping diagnostics**



**Wind load calculations**



**Refurb and new build specification writing services**



**Drainage calculations and rainfall modelling**

For absolute peace of mind, Profiles is protected by a range of guarantees covering both system and IMA-installed workmanship for up to 30 years, giving you greater confidence in the lifetime performance of your roof, as well as reducing risk and responsibility.



**Discover our flat roofing services and support online**

\*B<sub>ROOF</sub>(t4) defines the highest external fire performance for roofs. BMI Icopal flat roofing systems have been extensively tested and attained B<sub>ROOF</sub>(t4) classification.

BMI Icopal Technical Services Team are happy to support you with the design and specification of a B<sub>ROOF</sub>(t4) compliant flat roof system to meet the specific needs of your project.



# A proven system

**Whether torch-applied or thermally activated, Icopal Profiles systems are designed to add exceptional value – from rain water management to thermal waterproofing solutions.**

The different system layers of Profiles offer combinations which are best aligned to the substrate and performance needs of any particular roof;



## PRIMER

Primer is used to prepare the substrate for application of the waterproofing system and ensure a secure bond. The type of primer used is dependent on whether a thermally activated or torch-on system is selected.



## VAPOUR CONTROL LAYER

In a warm roof system, a vapour control layer (VCL) should be used beneath the insulation to control the diffusion of water vapour into the warm roof system.



## INSULATION

High-performance rigid foam insulation (PIR) is used for thermal performance, and specialist board facings ensure compatibility with the system. Icopal thermal performance calculations and tapered insulation designs are also available to support your project.



## UNDERLAY

The Icopal dispersion underlay features partial bond bitumen stripes to the underside. These play a vital role in the system, allowing trapped water vapour to disperse, providing an optimal pressure equalising effect and blister prevention.



## CAP SHEET

Icopal high-performance, low-melt, reinforced elastomeric bitumen cap sheets, with built-in groove technology, provide the ultimate waterproofing and UV protection, encapsulating the flat roof system.



Safe2Torch compliant Profiles systems are available for combustible substrates, with a combination of self-adhesive membranes using a thermally activated application, finished with a Safe2Torch-compliant, torch-applied cap sheet.

Torch applied Profiles systems are suitable for non-combustible substrates and where they are to be used adjacent to combustible materials. They can be customised with a build-up of torch-applied membranes and a Profiles cap sheet.

# Example Profiles system

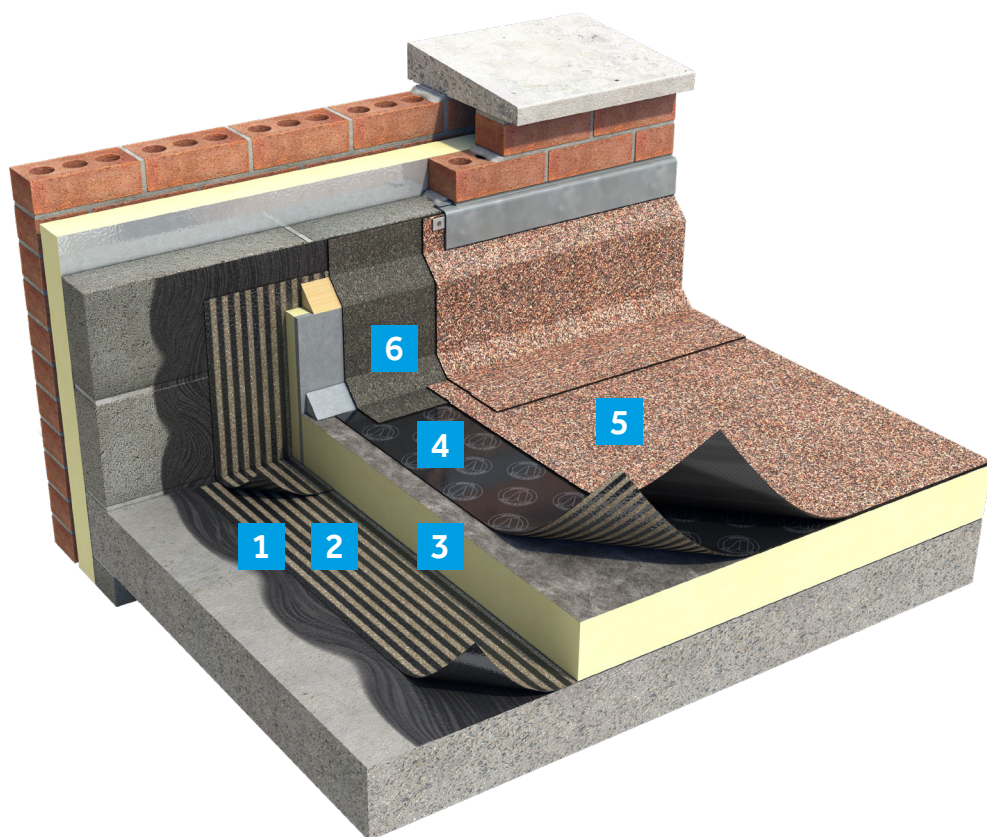

## Typical system build up:

	System layer	Product
1	Primer	<b>SA Primer</b>
2	Vapour control	<b>TorchSafe TA VCL Sanded</b>
3	Insulation	<b>Roofboard</b>
4	Underlay	<b>TorchSafe TA Underlay</b>
5	Cap sheet	<b>Profiles XL FireSmart Plus</b>
6	Detailing underlay	<b>TorchSafe TA Detailing Underlay</b>



Have you tried the  
Icopal [bitumen system selector online?](#)



# Case study

PROJECT	LOCATION	REASONS FOR WORKS
<b>John Lewis Distribution Hub</b>	<b>Killingworth, Newcastle Upon Tyne</b>	<b>Planned preventative maintenance</b>

**The roof of the John Lewis Distribution Hub was nearing the end of its life and so a planned preventative maintenance project was developed, led by Ridge and Partners, to ensure the distribution hub's roof remained fit for purpose.**

The roofing system is set across multiple roofs and with each roof potentially different challenges, BMI Icopal provided in-depth moisture mapping and roof surveys to better understand the condition of the roof and inform the specification proposal and advice provided to Ridge and Partners.

Using in-depth moisture mapping the team reduced costs by 25%, while a complete, high-integrity Profiles system was installed by IMA professionals – delivering enduring quality without compromise.

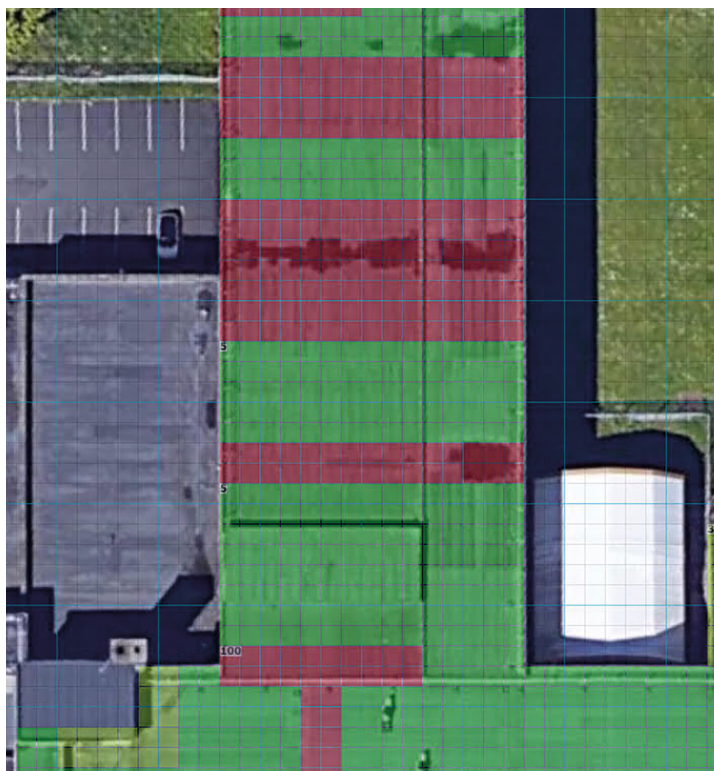

MOISTURE MAP OF JOHN LEWIS DISTRIBUTION HUB.

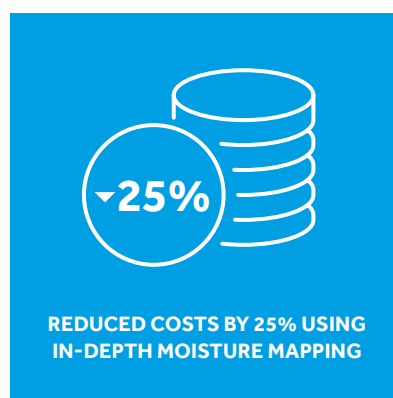

Start to finish. Specification to installation. Every stage of creating a Profiles bituminous roofing system delivers quality without compromise – from diagnostic technology that maps moisture and performance data, giving you the evidence to specify the right materials, to installation exclusively by IMA professionals, to the peace of mind of full-system guarantees and aftercare. In every service, in every angle, in every profile, you can see the difference. Profiles from BMI Icopal.

















**Quality without compromise.**



COMPLEXITY SIMPLIFIED: REPLACEMENT OF AZTEC WEST'S FLAT ROOF











# Profiles System components

	Product Name	Product Code	Dimensions	Kg per m²	Thickness	Torch-Applied or Self Adhesive	Description
Cap Sheets	Profiles XL FireSmart Plus	10001211	5x1m	 7.2	5.5mm		Profiles XL FireSmart Plus is intended for use as a torch-applied cap sheet in a bitumen built-up roof system.*
	Profiles XL FireSmart	10001215	7x1m	 5.3	4.5mm		Profiles XL FireSmart is intended for use as a torch-applied cap sheet in a bitumen built-up roof system.*
	Profiles Solo	10001231	7x1m	 5.4	4.5mm		Profiles Solo is intended for use as a torch applied single layer cap sheet in refurbishment applications.
	TorchSafe TA Detailing Cap Sheet	10001356	7x1m	 5.7	4.5mm		TorchSafe TA Detailing Mineral is intended for use as a heat activated detailing cap sheet in a built-up bitumen roof system.*
Underlays	Profiles Vent XL	10001117	7x1m	 5	3.6mm		Profiles Vent XL is intended for use as an underlay/base layer in a bitumen built-up roof system.*
	TorchSafe TA Underlay	10001232	10x1m	 5.8	3mm		TorchSafe TA Underlay is intended for use as an underlay/base layer in a bitumen built-up roof system.
Detailing Underlays	TorchSafe TA Detailing Underlay	10001356	10x1m	 3.4	3mm		TorchSafe TA Detailing Underlay is intended for use as a fully bonded underlay in a bitumen built-up roof system.
	Profiles XL Sanded	10001113	7x1m	 5.7	4.3mm		Profiles XL Sanded is a polyester reinforced SBS-modified bitumen membrane for use as a fully bonded underlay in a bitumen built-up roof system.

PLEASE SEE FURTHER INFORMATION AND ADDITIONAL COMPONENTS ON THE FOLLOWING PAGE.

\*The standard colour for cap sheets is charcoal. Alternative colours are available subject to minimum order quantities.

# Profiles System components

	Product Name	Product Code	Dimensions	Kg per m²	Thickness	Torch-Applied or Self Adhesive	Description
Vapour Control Layers	Profiles Vapour Vent XL	10001112	7x1m	 4.2	3.5mm		Profiles Vapour Vent XL is intended for use as an air & vapour control layer in a warm roof system build-up.
	TorchSafe TA VCL Stripes	10001442	7.5x1m	 3.5	3.5mm		TorchSafe TA VCL Stripes is intended for use as an air & vapour control layer in a warm roof system build-up.
	TorchSafe TA VCL Sanded	10001443	15x1m	 3.8	3.5mm		TorchSafe TA VCL Sanded is intended for use as an air & vapour control layer in a warm roof system build-up.
Primers	SA Primer	20000724		-	-	-	SA Primer is designed to improve the bond adhesion of self adhesive/heat-activated bituminous membranes to a variety of substrates including plywood, OSB, metal and insulation.
	Siplast Primer	10001450		-	-	-	Siplast Primer is designed to penetrate and seal substrates of masonry, concrete, cementitious screeds or renders, existing bituminous or asphalt waterproofing, structural steelwork and other metals, prior to the application of torch-applied bituminous membranes.
Preparation Layers	HT125 Taping Strip	10001147	16x0.15m	 1.9	1.7mm	Nailed	HT 125 Taping Strip is a polyester reinforced bitumen membrane used at plywood and OSB board joints.

	Product Name		Description
Insulation Layers	Thermazone Roofboard	BMI Icopal Thermazone tapered insulation provides a technically excellent solution to thermal insulation and bespoke drainage on flat roofing that avoids water retention.	PIR is one of the most efficient insulation materials used in construction, it provides acoustic and thermal properties. It is rigid and durable and is commonly used in warm roof build ups. Thermazone Roofboard is available in flat or tapered formats.
	Thermazone Torch-On	 Contact our <a href="#">technical services department</a> for bespoke tapered insulation schemes.	PIR is one of the most efficient insulation materials used in construction, it provides acoustic and thermal properties. It is rigid and durable and is commonly used in warm roof build ups. Thermazone Torch-On is available in flat or tapered formats.



**BMI UK & Ireland**

BMI House, 2 Pitfield, Kiln Farm,  
Milton Keynes, MK11 3LW  
0330 123 4585  
[technical.uk@bmigroup.com](mailto:technical.uk@bmigroup.com)

[bmigroup.com/uk](http://bmigroup.com/uk)

For further information and to ensure you are using the most up-to-date version of all BMI Documentation please visit [www.bmigroup.com/uk](http://www.bmigroup.com/uk) or contact the BMI Technical Services Team. Date of issue - February 2023.



Visit our website to  
get in touch about  
[Profiles flat roof systems](#)